

Marine Trader 34 Double Cabin

1972-2001

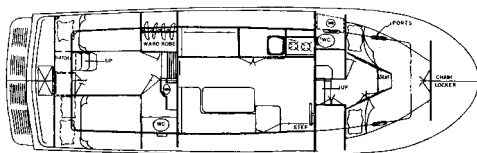

Original Layout

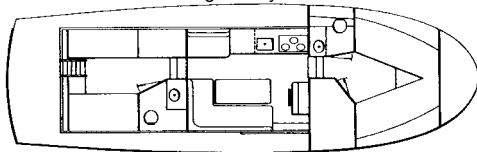

Late-Model Interior

An industry classic, the Marine Trader 34 Double Cabin is the best-selling small trawler ever imported and sold in the U.S. Built by CHB in Taiwan, there were other distributors besides Marine Trader and she may be recognized on the West Coast as the La Paz, Eagle, or CHB 34 DC. She enjoyed her best years during the 1970s when powerboats, with their big fuel-guzzling engines, were out of favor. There were several updates to the 34 over the years. Prior to 1975 she was built with a plywood house and a fiberglass cloth overlay. Until 1985 the decks were teak-planked and fastened through fiberglass to a balsa sub-deck—a constant source of deck leaks—and after 1985 the 34 was constructed of solid fiberglass. The flybridge was revised in 1991, and the teak window frames were eliminated in 1992. Below decks, the all-teak interior is arranged with small staterooms fore and aft, two heads and a very practical passageway from the aft stateroom to the cockpit. A lower helm is standard, and a sliding salon door provides easy access to the deck. No one will ever confuse the Marine Trader 34 with a Grand Banks when it comes to quality. A single 135hp Lehman diesel will cruise at 7 knots burning just 2-3 gallons per hour.

www.powerboatguide.com

Length Overall.....	33'6"	Headroom.....	6'4"
Length WL.....	30'3"	Fuel.....	300 gals.
Beam.....	11'9"	Water.....	150 gals.
Draft.....	3'6"	Waste.....	40 gals.
Weight.....	17,000#	Hull Type.....	Semi-Disp.